



IMPACT WRENCHES - 3/8" 1/2" 3/4" Sq. Drive

APPLICATIONS

Disassembling the engines of cars and motorcycles. Tire changing. Disassembling and assembling construction machineries, and its maintenance.

● AK-135 3/8" (9.5mm) sq. drive



Single Hammer

● AK-150ST 1/2" (12.7mm) sq. drive



1/2" (12.7mm) sq. drive

New Model

**LIGHTEST WEIGHT
&
MOST COMPACT**

COMPOSITE HOUSING

● AK-170T 1/2" (12.7mm) sq. drive



Twin Hammer

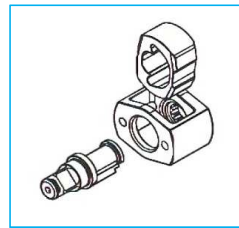

Jumbo Hammer

● AK-845 1/2" (12.7mm) sq. drive



Pin Clutch

● AK-845L AK-845 with 2" Long Anvil



Pin Clutch

PRODUCTION SUSPENDED

● AK-156 3/4" (19mm) sq. drive



Pin Clutch

● AK-156L AK-156 with 2.5" Long Anvil



Pin Clutch

Model	Square Drive (mm)	Bolt Cap. (mm)	Max. Torque (N·m)	Air Cons. (L/min.)		Free Speed (rpm)	Air Inlet (inch PT)	Net Weight (kg)	Length (mm)
				(no load)	(load)				
AK-135	9.5	10	100	380	320	9,000	1/4	1.33	136
AK-150ST	12.7	16	470	340	480	9,500	1/4	1.15	112
AK-170T	12.7	16	900	530	380	7,000	1/4	2.2	195
AK-845	12.7	16	450	480	350	7,000	1/4	2.26	187
AK-845L	12.7	16	450	480	350	7,000	1/4	2.35	225
AK-156	19	25	900	680	400	5,300	1/4	3.7	215
AK-156L	19	25	900	680	400	5,300	1/4	3.8	253